

膜付グロメット KG-SG

仕様・用途

仕様 材質 EPDM=黒
 EPDM=カラー 【受注生産】
 アイボリー・ホワイト・ブラウン(茶系) ライトグリーン(グレー系)
 硬度 50°±5
 用途 配電盤・制御盤・計測機器等

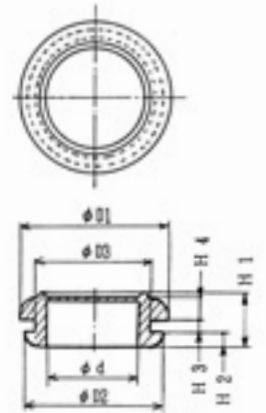

黒 : B カラー : C

防塵タイプ

| 5825 番号 | 旧 番号 | H1 | H2 | H3 | H4 | ϕ D1 | ϕ D2 | ϕ D3 | ϕ d | 重量 (g) | F 番号 | 備考 |
|---------------------|---------------|------|-----|-----|-----|-----------|-----------|-----------|----------|--------|---------------|----|
| KG-SG09B SG09C | SG-9A // | 8.5 | 2.0 | 2.3 | 3.5 | 16.0 | 13.0 | 9.0 | 4.5 | 1.1 | SG-9F // | |
| KG-SG12B SG12C | SG-12A // | 6.3 | 1.5 | 1.6 | 2.5 | 19.0 | 16.0 | 12.0 | 7.0 | 2.0 | SG-12F // | |
| KG-SG14B SG14C | SG-14A // | 8.0 | 2.0 | 2.3 | 3.0 | 21.0 | 18.0 | 14.0 | 9.0 | 2.0 | SG-14F // | |
| KG-SG16B SG16C | SG-16A // | 8.1 | 2.0 | 1.6 | 3.5 | 23.0 | 20.0 | 15.0 | 11.0 | 2.8 | SG-16F // | |
| KG-SG18B SG18C | SG-18A // | 8.8 | 2.0 | 2.3 | 3.5 | 25.0 | 22.0 | 18.0 | 12.0 | 3.5 | SG-18F // | |
| KG-SG20B SG20C | SG-20A // | 9.1 | 2.5 | 1.6 | 4.0 | 27.0 | 24.0 | 20.0 | 15.0 | 4.3 | SG-20F // | |
| KG-SG22B SG22C | SG-22A // | 9.8 | 2.5 | 2.3 | 4.0 | 29.0 | 26.0 | 22.0 | 17.0 | 3.8 | SG-22F // | |
| KG-SG24B SG24C | SG-24A // | 11.3 | 3.0 | 2.3 | 5.0 | 31.0 | 28.0 | 24.0 | 19.0 | 6.3 | SG-24F // | |
| KG-SG26B SG26C | SG-26A // | 12.2 | 3.0 | 3.2 | 5.0 | 35.0 | 31.0 | 26.0 | 19.0 | 8.8 | SG-26F // | |
| KG-SG28B SG28C | SG-28A // | 11.8 | 3.0 | 2.3 | 5.0 | 37.0 | 33.0 | 28.0 | 21.0 | 9.3 | SG-28F // | |
| KG-SG30B SG30C | SG-30A // | 12.7 | 3.0 | 3.2 | 5.0 | 39.0 | 35.0 | 30.0 | 23.0 | 9.8 | SG-30F // | |
| KG-SG32B SG32C | SG-32A // | 11.8 | 3.0 | 2.3 | 5.0 | 41.0 | 37.0 | 32.0 | 25.0 | 9.5 | SG-32F // | |
| KG-SG34B SG34C | SG-34A // | 12.7 | 3.0 | 3.2 | 5.0 | 43.0 | 39.0 | 34.0 | 27.0 | 10.9 | SG-34F // | |
| KG-SG36B SG36C | SG-36A // | 13.8 | 4.0 | 2.3 | 6.0 | 45.0 | 42.0 | 36.0 | 28.0 | 13.0 | SG-36F // | |
| KG-SG38B SG38C | SG-38A // | 14.7 | 4.0 | 3.2 | 6.0 | 48.0 | 44.0 | 38.0 | 30.0 | 14.5 | SG-38F // | |
| KG-SG42B SG42C | SG-42A // | 14.7 | 4.0 | 3.2 | 6.0 | 52.0 | 48.0 | 42.0 | 34.0 | 15.7 | SG-42F // | |
| KG-SG44B SG44C | SG-44A // | 15.0 | 4.0 | 3.5 | 6.0 | 54.0 | 50.0 | 44.0 | 36.0 | | | |
| KG-SG46B SG46C | SG-46A // | 15.0 | 4.0 | 3.5 | 6.0 | 56.0 | 51.0 | 46.0 | 36.0 | | | |
| KG-SG48B SG48C | SG-48A // | 15.0 | 4.0 | 3.5 | 6.0 | 58.0 | 53.0 | 48.0 | 38.0 | | | |
| KG-SG50B SG50C | | 13.7 | 4.0 | 3.2 | 6.5 | 60.0 | 55.0 | 50.0 | 40.0 | 20.3 | SG-50F // | |
| KG-SG52B SG52C | SG-52A // | 15.0 | 4.0 | 3.5 | 6.0 | 62.0 | 57.0 | 52.0 | 42.0 | | | |
| KG-SG54B SG54C | SG-54A // | 15.0 | 4.0 | 3.5 | 6.0 | 64.0 | 59.0 | 54.0 | 44.0 | | | |
| KG-SG56B SG56C | SG-56A // | 15.0 | 4.0 | 3.5 | 6.0 | 66.0 | 60.0 | 56.0 | 46.0 | | | |
| KG-SG58B SG58C | SG-58A // | 15.0 | 4.0 | 3.5 | 6.0 | 68.0 | 63.0 | 58.0 | 48.0 | | | |
| KG-SG60B SG60C | | 13.7 | 4.0 | 3.2 | 6.5 | 70.0 | 65.0 | 60.0 | 50.0 | 20.7 | SG-60F // | |
| KG-SG62B SG62C | SG-62A // | 15.0 | 4.0 | 3.5 | 6.0 | 73.0 | 67.0 | 62.0 | 54.0 | | | |
| KG-SG64B SG64C | SG-64A // | 15.0 | 4.0 | 3.5 | 6.0 | 74.0 | 69.0 | 64.0 | 54.0 | | | |
| KG-SG66B SG66C | SG-66A // | 15.0 | 4.0 | 3.5 | 6.0 | 76.0 | 70.0 | 66.0 | 56.0 | | | |
| KG-SG70B SG70C | | 13.7 | 4.0 | 3.2 | 6.5 | 80.0 | 75.0 | 70.0 | 60.0 | 30.3 | SG-70F // | |
| KG-SG80B SG80C | | 14.2 | 4.5 | 3.2 | 6.5 | 90.0 | 85.0 | 80.0 | 70.0 | | SG-80F // | |
| KG-SG100B SG100C | | 16.7 | 5.0 | 3.2 | 7.0 | 110.0 | 105.0 | 100.0 | 90.0 | 58.0 | SG-100A // | |
| KG-SG120B SG120C | SG-120A // | 17.2 | 5.0 | 4.0 | 7.5 | 130.0 | 125.0 | 120.0 | 110.0 | | | |